

# FOYER AX B 1100 BOMBE POST-COMBUSTION



Standard NF – EN 13229 Guaranteed by C.T.I.F.  
Type : I.S.B. SF. EM

- nominal power : 14 kwh
- consumption : 5.60 kgh
- appliance Co : 0.16 %
- appliance efficiency : 66.5 %
- % of losses by non burning solids : 0
- autonomy of heater => 10 H 00 am with inertia of the fireproof
- autorized fuel : wood to 15% of humidity

## CONDITION OF EXPLOITATION

- imperative fresh inflow of air : 300 cm<sup>2</sup> minimum
- inflow of air convection : 600 cm<sup>2</sup> minimum, so necessary to kick away the detachable opercules.
- Hot air outlets : 647 cm<sup>2</sup> minimum

## STANDARD EQUIPEMENTS

- order of valve exhaust of smoke with automatic opening when the door lift up
- carenage of door
- dubbing of convection
- directional and detachable inflows of fresh air
- removable feet
- smoke evacuation Ø 250 – hot air outlets Ø 125 ( 4 )

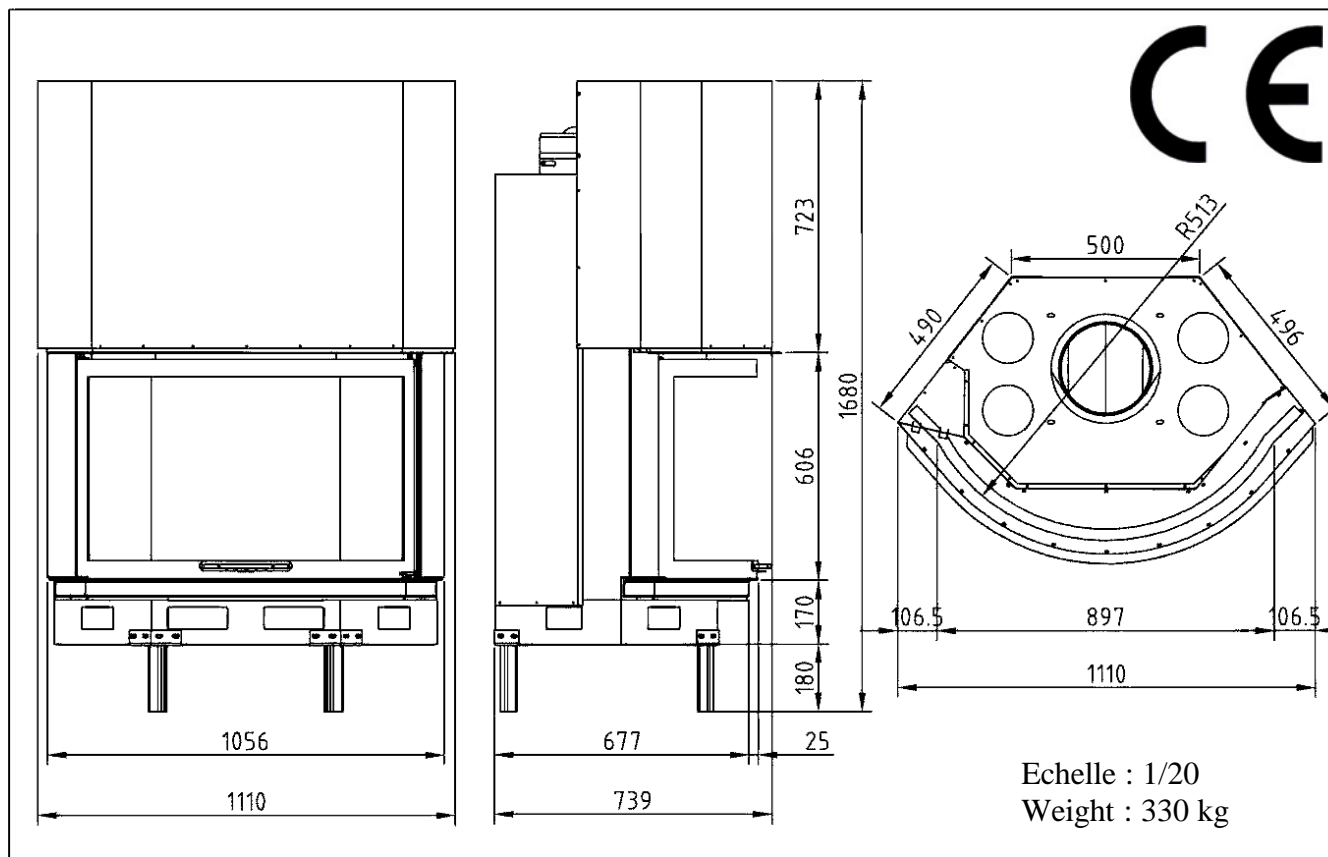

AXIS : ZA La Pélessière – 01300 BELLEY FRANCE

Tél : 33 (0)4 79 81 10 50 – Fax : 33 (0)4 79 42 21 24

Email : mbondot@aol.com / Site internet : [www.cheminees-axis.com](http://www.cheminees-axis.com)